

L-M12-1M03320S30

S-Mount Lens M12 x 0.5

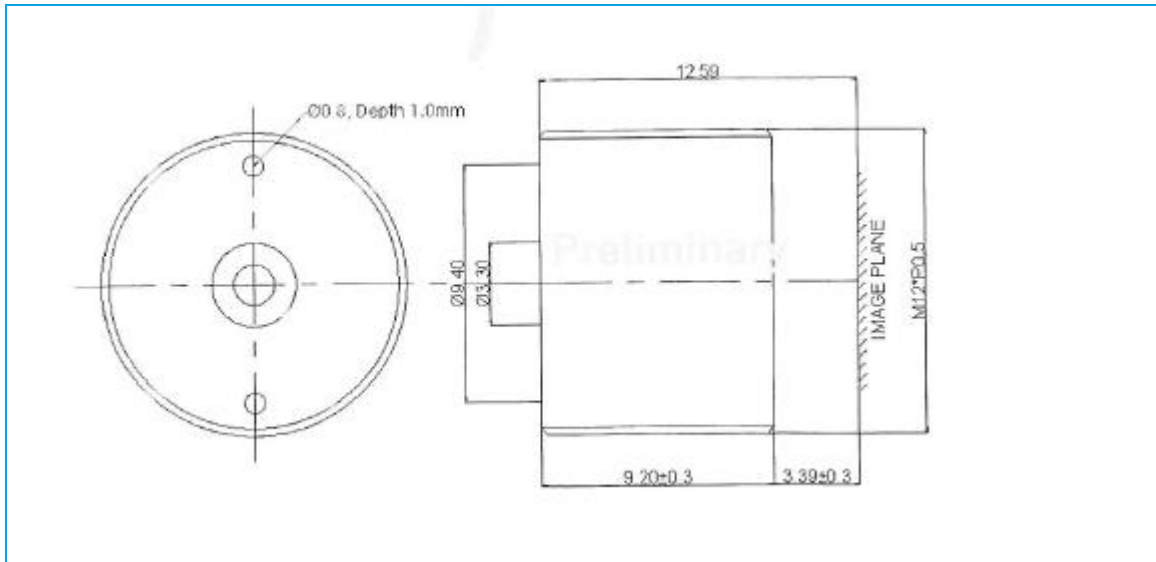

Coverage area	1/3"			1/4"			Tolerance
H/V/D FOV (°)	77.0	55.1	130.0	55.1	39.1	72.7	+/-3(D)
Effective Focal Length (mm)	3.3						
Working F/#	2.0						
Distortion (%)	-66.4%@1.3", -23.8%@1/4"						
Back Focal Length(mm)	3.41						
Flange Back Focal Length(mm)	3.39						
Track In Total (mm)	12.59						
Thread	M12*P0.5						
Retaining Ring (Ø)	N/A						
Lens Construction	5						-
Filter	N/A						