

L-M12-8M0492223

S-Mount Lens M12 x 0.5

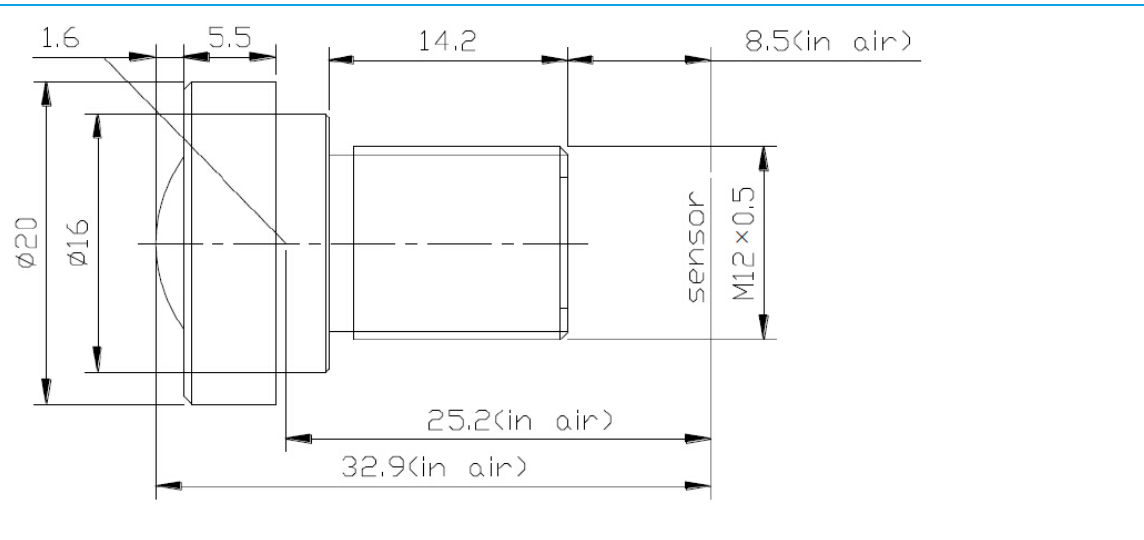

IMAGE FORMAT	1/2.3"
FOCAL LENGTH	4.9mm
F.O.V.	90°(D)
	73°(H)
	61°(V)
RESOLUTION	10 MP
DISTORTION	<-19%
APERTURE	F2.2
MOUNT	M12x0.5
IRIS	Fixed
M.O.D.	0.3m
T.T.L.	32.9mm
DIMENSION	Φ20x24.4mm
IR	Corrected

Rev. 1.01-1802

Please note that all data and illustrations are subject to error, change and omissions without notice.