



## VL-HR SERIES

- Suitable for the detection of small convex and concave defects on surface.
- Ideal to emphasize the edge-crack.
- RoHS Compliant.

Model No.	Color	Internal Ring Dia. (mm)	External Ring Dia. (mm)	Power Consumption (Max.)	
VL-HR4675R	● Red	φ46	φ75	24V	1.6W
VL-HR4675W	○ White				2.6W
VL-HR4675B	● Blue				2.7W
VL-HR110146R	● Red	φ 110	φ 146	24V	3.1W
VL-HR110146W	○ White				5.0W
VL-HR110146B	● Blue				5.6W

VL-HR4675\*

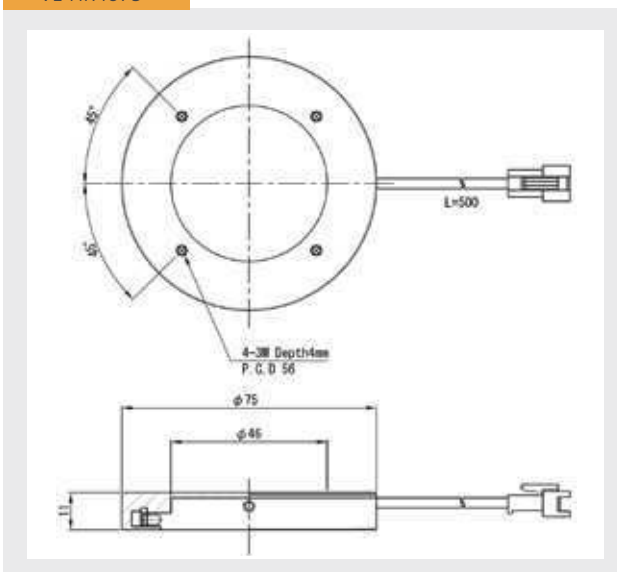

VL-HR110146\*

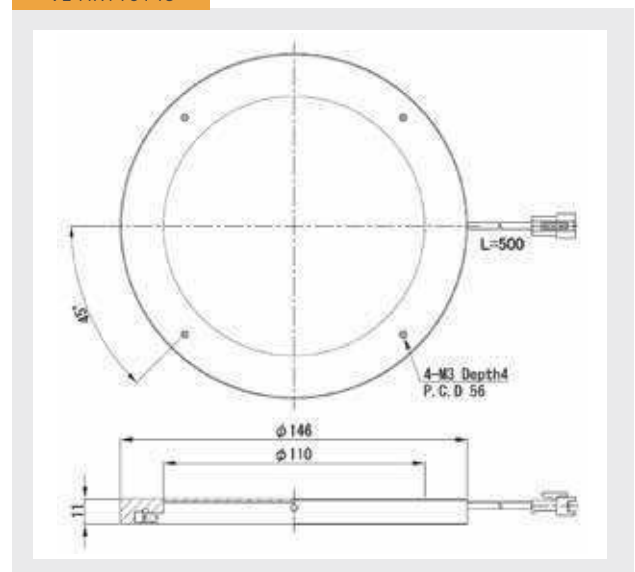

Sample Image of VL-HR. Surface edge / fiber / dust / crack etc.

