

LOW ANGLE RING DIFFUSED LIGHT



VL-LRDH SERIES

- High-power design
- Low angle ring diffused light model.
- Suitable for inspection of glossy object.
- Prevention of LED glare and reflections.
- Light evenly spread out onto the objects surface.
- RoHS compliant.

Model No.	Color	Internal Ring Dia. (mm)	External Ring Dia. (mm)	Power Consumption (Max.)
VL-LRDH116166R	● Red	φ 116	φ 166	24V
VL-LRDH116166W	○ White			
VL-LRDH116166B	● Blue			
VL-LRDH116166G	● Green			
VL-LRDH4090W	○ White	φ 40	φ 90	9.6W

Brightness comparison between LRDH and 3rd company models



VL-LRDH116166*

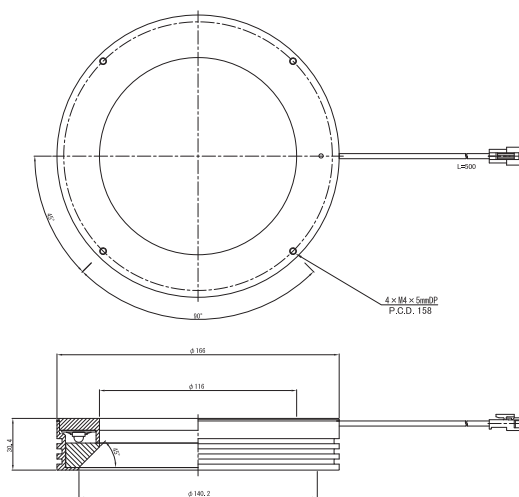

VL-LRDH4090*

